

**OLÁ!
I AM SMASHY**

what you need to
know about me

**PLAYABLE DURING
RED LIGHT**

**WAITING IS NO
LONGER BORING**

**PLAY ON RED,
WALK ON GREEN**

APP AVAILABLE

HIT THE HIGHSORE!

SMASH

SMASHY

Hey! I'm Smashy, at lights I stand,
Red's my cue to lend a hand.
When green shines bright, our
game is done,
Cross safely now, the victory's
won.

**CHECK OUT OUR
NEW APP**

WELCOME TO
SMASHY

**BEAT THE
HIGHSORE!**

QR code

ME

HOW TO PLAY

- 1. **DOWNLOAD APP**
 - 2. **HOLD YOUR PHONE TO THE NFC-READER**
 - 3. **SMASH VERY QUICKLY**
- !
**LOW LEVEL
MORE TIME**
- !!
**HIGH LEVEL
LESS TIME**
- :(
**TOO SLOW
GAME OVER**
- :)
**HOLD ON
FOR FEW SE-
CONDS**
- WIN**

DESCRIPTION

FRONTSIDE

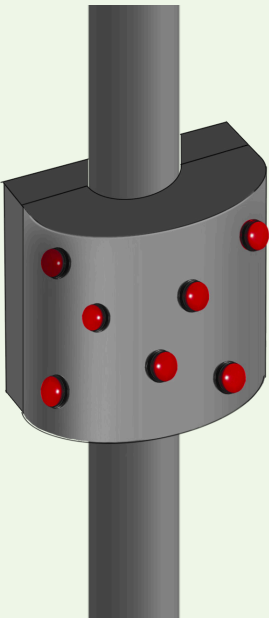

Our product, 'SMASHY,' consists of two parts that are attached around the traffic light. SMASHY is constructed from high-density polyethylene and stainless steel, making it both weatherproof and robust. This durability is crucial not only for the product's longevity but also for its sustainability.

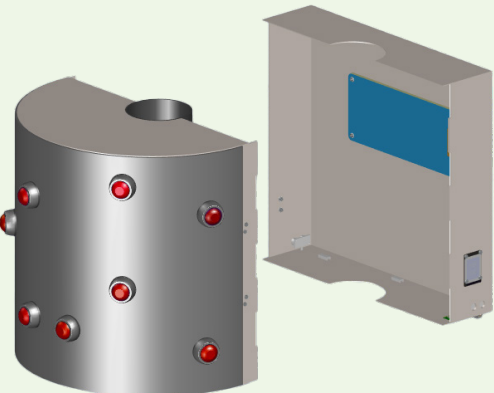

BACKSIDE



For the electrotechnical component, an LED matrix display, an NFC reader for mobile phone connectivity, a mechanism to count the crossers, and a Raspberry Pi Pico chip for programming are installed.

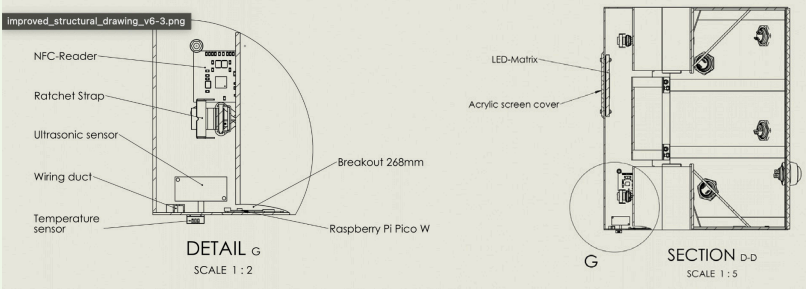

SOCIAL MEDIA

